

UCPL Pillow Blocks

Standard duty. Low shaft height with set screw lock.

- Cast iron housing
- Wide inner race bearing
- B-type or L3-type seals



B-type Seal



L3-type Seal

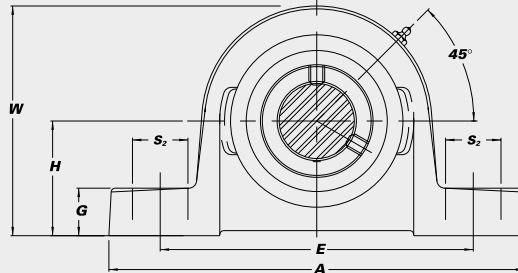
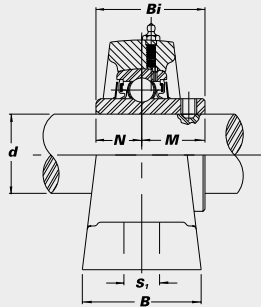

Unit No.	Shaft Dia.		Dimensions											Bolt Used	Bearing No.	Housing No.	Weight (lbs.)	
	d	d	H	A	E	B	S ₂	S ₁	G	W	Bi	N	M					
	(in.)	(mm)												(in.)				
UCPL 201		12																UCW201
201-8	1/2																	201-8
202		15	1 1/16	4 7/8	3 5/8	1 7/16	3/4	7/16	1 7/32	2 15/64	1.0236	0.3937	0.6299	3/8			202	
202-10	5/8		27	124	92	37	19	11	13	57	26.0	10.0	16.0				202-10	
203		17															203	
UCPL 204-12	3/4																	UC 204-12
204		20	1 1/4	5	3 3/4	1 1/2	9/16	7/16	9/16	2 1/2	1.2205	0.5000	0.7205	3/8			204	
UCPL 205-14	7/8																	UC 205-14
205-15	15/16		1 5/16	5 1/2	4 1/8	1 1/2	11/16	7/16	5/8	2 49/64	1.3386	0.5630	0.7756	3/8			205-15	
205		25	33.3	140	105	38	18	11	16	69	34.0	14.3	19.7				205	
205-16	1																205-16	
UCPL 206-17	1 1/16																	UC 206-17
206-18	1 1/8		1 7/16	6 1 1/32	4 3/4	1 3/4	13/16	9/16	1 1/16	3 5/32	1.5000	0.6260	0.8740	1/2			206	
206		30	39.7	161	121	45	21	14	18	80	38.1	15.9	22.2				206	
206-19	1 3/16																206-19	
206-20	1 1/4 S																206-20	
UCPL 207-20	1 1/4																	UC 207-20
207-21	1 5/16		1 13/16	6 1 1/32	5	1 7/8	7/8	9/16	25/32	3 1/32	1.6890	0.6890	1.0000	1/2			207-21	
207-22	1 3/8		46.0	167	127	48	22	14	20	93	42.9	17.5	25.4				207-22	
207		35															207	
207-23	1 1/16																207-23	
UCPL 208-24	1 1/2																	UC 208-24
208-25	1 7/16		1 15/16	7 1/8	5 7/16	2	7/8	9/16	13/16	4	1.9370	0.7480	1.1890	1/2			208-25	
208		40	49.2	181	137	51	22	14	21	102	49.2	19.0	30.2				208	
UCPL 209-26	1 5/8																	UC 209-26
209-27	1 11/16		2 1/16	7 1/2	5 3/4	2 1/8	13/16	9/16	29/32	4 7/32	1.9370	0.7480	1.1890	1/2			209-27	
209-28	1 3/4		52.4	191	146	54	20	14	23	107	49.2	19.0	30.2				209-28	
209		45															209	
UCPL 210-30	1 7/8																	UC 210-30
210-31	1 5/8		2 3/16	8 1/32	6 1/4	2 1/4	15/16	1 1/16	29/32	4 29/64	2.0315	0.7480	1.2835	5/8			210-31	
210		50	55.6	204	159	57	24	18	23	113	51.6	19.0	32.6				210	
210-32	2 S																210-32	
UCPL 211-32	2																	UC 211-32
211-34	2 1/8		2 1/16	8 5/8	7	2 3/8	15/16	1 1/16	1	4 61/64	2.1890	0.8740	1.3150	5/8			211-34	
211		55	61.9	219	178	60	24	18	25.4	126	55.6	22.2	33.4				211	
211-35	2 1/16																211-35	
UCPL 212-36	2 1/4																	UC 212-36
212		60	2 11/16	9 7/16	7 3/8	2 1/2	1	1 1/16	1 1/32	5 13/32	2.5630	1.0000	1.5630	5/8			212	
212-38	2 3/8		68.3	240	187	63	25.4	18	26.5	137	65.1	25.4	39.7				212-38	
212-39	2 1/16																212-39	
UCPL 213-40	2 1/2																	UC 213-40
213		65	2 11/16	9 3/4	7 5/8	2 3/4	1 1/8	1 1/16	1 1/8	5 7/16	2.5630	1.0000	1.5630	5/8			213	
UCPL 215-47	2 5/16																	UC 215-47
215		75	3 1/4	10 3/16	8 1/2	2 5/16	1 1/4	1	1 1/8	6 33/64	3.0630	1.3110	1.7520	7/8			215	
215-48	3		82.6	275	217	75	31	25.4	29	166	77.8	33.3	44.5				215-48	

Interchange Page 91