



UCP Pillow Blocks

Standard duty. High shaft height with set screw lock.

- Cast iron housing
- B-type or L3-type seals
- Wide inner race bearing



B-type Seal



L3-type Seal

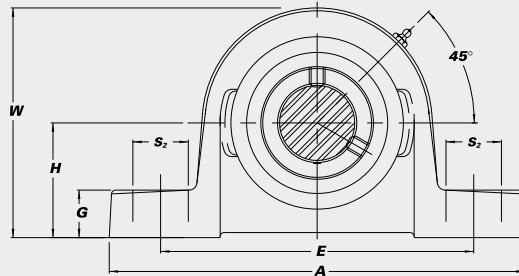
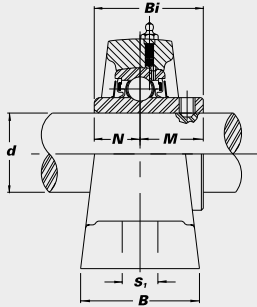

STANDARD PRODUCTS

Unit No.	Shaft Dia.		Dimensions (in. (mm))										Bolt Used (in.)	Bearing No.	Housing No.	Weight (lbs.)			
	d (in.)	d (mm)	H	A	E	B	S ₂	S ₁	G	W	Bi	N					M		
UCP 201		12															UCW 201		
201-8	1/2																		
202		15	1 3/16	4 7/8	3 5/8	1 7/16	3/4	7/16	1 7/32	2 23/64	1.0236	0.3937	0.6299	3/8				P 203	1.5
202-10	5/8		30.2	124	92	37	19	11	13	60	26.0	10.0	16.0						
203		17																	
UCP 204-12	3/4		1 5/16	5	3 3/4	1 1/2	1 1/16	7/16	9/16	2 19/32	1.2205	0.5000	0.7205	3/8			UC 204-12	P 204	1.6
204		20	33.3	127	95	38	17	11	14	66	31.0	12.7	18.3						
UCP 205-14	7/8		1 7/16	5 1/2	4 1/8	1 1/2	1 1/16	1/2	5/8	2 27/32	1.3386	0.5630	0.7756	3/8			UC 205-14	P 205	2.0
205-15	1 5/16		36.5	140	105	38	17	13	16	72	34.0	14.3	19.7						
205		25																	
205-16	1																		
UCP 206-17	1 1/4		1 11/16*	6 5/16	4 3/4	1 3/4	1 3/16	9/16	1 1/16	3 19/64	1.5000	0.6260	0.8740	1/2			UC 206-17	P 206	3.0
206-18	1 1/8		42.9	160	121	44	21	14	18	84	38.1	15.9	22.2						
206		30																	
206-19	1 3/16																		
206-20	1 1/8 S																		
UCP 207-20	1 1/4		1 7/8	6 17/32	5	1 29/32	7/8	9/16	3/4	3 11/16	1.6890	0.6890	1.0000	1/2			UC 207-20	P 207	4.0
207-21	1 5/16		47.6	166	127	48	22	14	19	94	42.9	17.5	25.4						
207-22	1 3/8																		
207		35																	
207-23	1 7/16																		
UCP 208-24	1 1/2		1 15/16**	7 1/8	5 1/16	2	7/8	9/16	1 3/16	4	1.9370	0.7480	1.1890	1/2			UC 208-24	P 208	5.0
208-25	1 1/16		49.2	181	137	51	22	14	21	102	49.2	19.0	30.2						
208		40																	
UCP 209-26	1 5/8		2 1/8	7 1/2	5 3/4	2 1/8	1 3/16	1 9/32	7/8	4 17/64	1.9370	0.7480	1.1890	1/2			UC 209-26	P 209	5.7
209-27	1 11/16		54.0	190	146	54	21	15	22	109	49.2	19.0	30.2						
209-28	1 3/4																		
209		45																	
UCP 210-30	1 7/8		2 1/4	8	6 1/4	2 1/4	1 5/16	2 3/32	1 5/16	4 33/64	2.0315	0.7480	1.2835	5/8			UC 210-30	P 210	6.8
210-31	1 5/16		57.2	203	159	57	24	18	24	115	51.6	19.0	32.6						
210		50																	
210-32	2 S																		
UCP 211-32	2		2 1/2	8 5/8	6 1/8	2 3/8	1 5/16	2 3/32	1 1/16	5 1/32	2.1890	0.8740	1.3150	5/8			UC 211-32	P 211	8.8
211-34	2 1/8		63.5	220	174	60	24	18	27	128	55.6	22.2	33.4						
211		55																	
211-35	2 3/16																		
UCP 212-36	2 1/4		2 3/4	9 17/32	7 11/32	2 1/2	1	2 5/32	1 1/16	5 23/64	2.5630	1.0000	1.5630	5/8			UC 212-36	P 212	11.2
212		60																	
212-38	2 3/8		69.8	242	187	64	25.4	20	27	140	65.1	25.4	39.7						
212-39	2 1/16																		
UCP 213-40	2 1/2		3	10 3/4	8 1/8	2 1/2	1 3/16	1 3/16	1 1/8	6 1/32	2.5630	1.0000	1.5630	5/8			UC 213-40	PX12	14.1
213		65	76.2	273	206	64	30	20	28	153	65.1	25.4	39.7						
UCP 214-43	2 11/16		3	10 3/4	8 1/8	2 1/2	1 3/16	1 3/16	1 1/8	6 1/32	2.9370	1.1890	1.7480	5/8			UC 214-43	PX13	14.5
214-44	2 3/4		76.2	273	206	64	30	20	28	153	74.6	30.2	44.4						
214		70																	
UCP 215-47	2 5/16		3 1/4	10 13/16	8 1/2	2 5/16	1 1/4	1	1 1/8	6 23/64	3.0630	1.3110	1.7520	7/8			UC 215-47	P 215	17.0
215		75	82.6	275	217	75	31	25.4	29	166	77.8	33.3	44.5						
215-48	3																		

Interchange Page 91. *Also available 1 5/8" **Also available 2 1/8"