

SUCSF 4-Bolt Flange Units



All Stainless Steel

- B-type seals
- Sizes 1/2" - 1 1/2" available with end caps — "Cap Ready"



B-type Seal

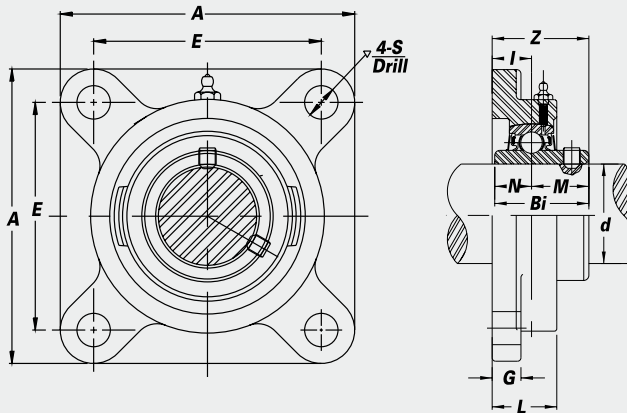

CORROSION RESISTANT

Unit No.	Shaft Dia.		Dimensions (in./mm)										Bolt Used (in.)	Bearing No.	Housing No.	Weight (lbs.)
	d (in.)	d (mm)	A	E	I	G	L	S	Z	Bi	N	M				
SUCSF 201-8 202-10	1/2 5/8	12.7 15.9	3 3/8 86	2 1/2 64	1 9/32 15	7/16 11	1 25.4	7/16 11	1 5/16 33.3	1.2205 31.0	0.5000 12.7	0.7205 18.3	3/8	SUC 201-8 202-10	SF 204	1.8
SUCSF 204-12 204	3/4	19.0	3 3/8 86	2 1/2 64	1 9/32 15	7/16 11	1 25.4	7/16 11	1 5/16 33.3	1.2205 31.0	0.5000 12.7	0.7205 18.3	3/8	SUC 204-12 204	SF 204	1.6
SUCSF 205-14 205 205-16	7/8 1	22.2 25.4	3 3/4 95	2 3/4 70	5/8 16	1/2 13	1 1/16 27	2 9/64 11.5	1 3/32 35.7	1.3386 34.0	0.5630 14.3	0.7756 19.7	3/8	SUC 205-14 205 205-16	SF 205	2.1
SUCSF 206-18 206 206-19 206-20	1 1/8 1 3/16 1 1/4 S	31.8 33.0 34.9	4 1/4 108	3 1/4 83	4 5/64 18	1/2 13	1 7/32 31	3 3/64 13	1 9/32 40.2	1.5000 38.1	0.6260 15.9	0.8740 22.2	7/16	SUC 206-18 206 206-19 206-20	SF 206	2.9
SUCSF 207-20 207-21 207-22 207 207-23	1 1/4 1 5/16 1 3/8 1 7/16	31.8 39.7 44.5 42.7	4 1 9/32 117	3 5/8 92	3/4 19	1 9/32 15	1 11/32 34	3 3/64 13	1 3/4 44.4	1.6890 42.9	0.6890 17.5	1.0000 25.4	7/16	SUC 207-20 207-21 207-22 207 207-23	SF 207	3.8
SUCSF 208-24 208	1 1/2	38.1	5 1/8 130	4 102	5 3/64 21	1 9/32 15	1 13/32 36	3 5/64 14	2 1/32 51.2	1.9370 49.2	0.7480 19.0	1.1890 30.2	1/2	SUC 208-24 208	SF 208	4.9
SUCSF 209-27 209-28 209	1 11/16 1 3/4	45.7 47.6	5 13/32 137	4 1/8 105	5 5/64 22	5/8 16	1 1/2 38	5/8 16	2 1/16 52.2	1.9370 49.2	0.7480 19.0	1.1890 30.2	9/16	SUC 209-27 209-28 209	SF 209	5.4
SUCSF 210-31 210 210-32	1 15/16 2 S	50.8 54.0	5 5/8 143	4 3/8 111	5 5/64 22	5/8 16	1 9/16 40	5/8 16	2 5/32 54.6	2.0315 51.6	0.7480 19.0	1.2835 32.6	9/16	SUC 210-31 210 210-32	SF 210	5.9
SUCSF 211-32 211-35	2 2 3/16	50.8 57.1	6 3/8 162	5 1/8 130	6 3/64 25	2 3/32 18	1 11/16 43	4 3/64 17	2 5/16 58.4	2.1890 55.6	0.8740 22.2	1.3150 33.4	5/8	SUC 211-32 211-35	SF 211	8.1
SUCSF 212-39	2 1/16	52.1	6 7/8 175	5 5/8 143	1 9/64 29	2 3/32 18	1 7/8 48	4 3/64 17	2 23/32 68.7	2.5630 65.1	1.0000 25.4	1.5630 39.7	5/8	SUC 212-39	SF 212	10.0

*Cap Ready mounted units include a specially grooved housing and a plastic end cap.