

SAPL Pillow Blocks

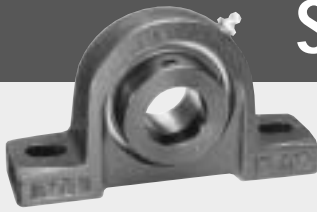

Low shaft height with eccentric locking collar.

- Cast iron housing
- K-type seals

- Narrow inner race bearing



K-type Seal

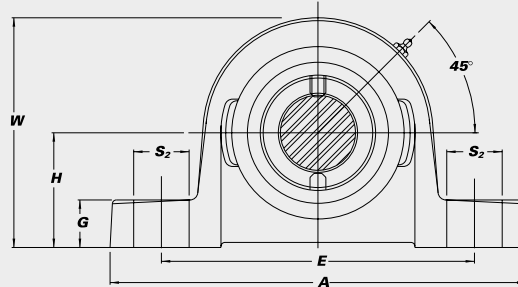
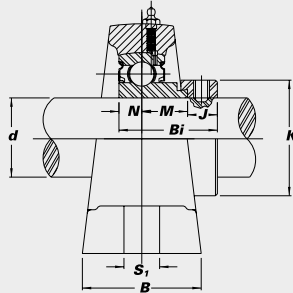

Unit No.	Shaft Dia.		Dimensions (in.) (mm)													Bolt Used (in.)	Bearing No.	Housing No.	Weight (lbs.)		
	d (in.)	d (mm)	H	A	E	B	S ₂	S ₁	G	W	Bi	N	M	J	K						
SAPL 201		12																SA 201G			
201-8	1/2																	201-8G			
202		15	1 1/16	4 7/8	3 5/8	1 7/16	3/4	7/16	17/32	2 15/64	1.1260	0.2559	0.4960	0.3740	1.1260		3/8	202G	PL 203	1.5	
202-10	5/8		27	124	92	37	19	11	13	57	28.6	6.5	12.6	9.5	28.6			202-10G			
203		17																203G			
SAPL 204-12	3/4																	SA 204-12G			
204		20	1 1/4	5	3 1/4	1 1/2	9/16	7/16	9/16	2 1/2	1.2205	0.2953	0.5512	0.3740	1.3110		3/8	204G	PL 204	1.7	
			31.8	127	95	38	14	11	14	64	31.0	7.5	14.0	9.5	33.3			204-12G			
SAPL 205-14	7/8																	SA 205-14G			
205-15	15/16																	205-15G			
205		25	1 5/16	5 1/2	4 1/8	1 1/2	11/16	7/16	5/8	2 5/64	1.2205	0.2953	0.5513	0.3740	1.5000		3/8	205G	PL 205	2.0	
205-16	1		33.3	140	105	38	18	11	16	69	31.0	7.5	14.0	9.5	38.1			205-16G			
SAPL 206-17	1 1/16																	SA 206-17G			
206-18	1 1/8																	206-18G			
206		30	1 9/16	6 11/32	4 3/4	1 3/4	13/16	9/16	1 1/16	3 3/32	1.4055	0.3543	0.5827	0.4685	1.7520		1/2	206G	PL 206	3.0	
206-19	1 3/16		39.7	161	121	45	21	14	18	80	35.7	9.0	14.8	11.9	44.5			206-19G			
206-20	1 1/4 S																	206-20G			
SAPL 207-20	1 1/4																	SA 207-20G			
207-21	1 3/16																	207-21G			
207-22	1 3/8		1 13/16	6 19/32	5	1 7/8	7/8	9/16	2 5/32	3 21/32	1.5315	0.3740	0.6260	0.5315	2.1890		1/2	207-22G	PL 207	4.0	
207		35	46.0	167	127	48	22	14	20	93	38.9	9.5	15.9	13.5	55.6			207G			
207-23	1 7/16																	207-23G			
SAPL 208-24	1 1/2																	SA 208-24G			
208-25	1 9/16																	208-25G			
208		40	1 15/16	7 7/8	5 7/16	2	7/8	9/16	1 3/16	4	1.7205	0.4331	0.7559	0.5315	2.3740		1/2	208G	P 208	5.0	
			49.2	181	137	51	22	14	21	102	43.7	11.0	19.2	13.5	60.3						
SAPL 209-26	1 5/8																	SA 209-26G			
209-27	1 11/16																	209-27G			
209-28	1 3/4																	209-28G	PL 209	6.1	
209		45	2 1/16	7 1/2	5 3/4	2 1/8	13/16	9/16	2 9/32	4 1/32	1.7205	0.4331	0.7559	0.5315	2.5000		1/2	209G			
			52.4	191	146	54	20	14	23	107	43.7	11.0	19.2	13.5	63.5						
SAPL 210-30	1 7/8																	SA 210-30G			
210-31	1 13/16																	210-31G			
210		50	2 3/16	8 1/32	6 1/4	2 1/4	15/16	1 1/16	2 9/32	4 29/64	1.7205	0.4331	0.7559	0.5315	2.7520		5/8	210G	PL 210	6.7	
210-32	2 S		55.6	204	159	57	24	18	23	113	43.7	11.0	19.2	13.5	69.9			210-32G			
SAPL 211-32	2																	SA 211-32G			
211-34	2 1/8																	211-34G			
211		55	2 1/16	8 5/8	7	2 3/8	15/16	1 1/16	1	4 61/64	1.9055	0.4724	0.8031	0.6299	3.0000		5/8	211G	PL 211	8.8	
211-35	2 3/16		61.9	219	178	60	24	18	25.4	126	48.4	12.0	20.4	16.0	76.2			211-35G			

Interchange Page 91