

NAPL Pillow Blocks



B-type Seal



L3-type Seal

Standard duty. Low shaft height with eccentric locking collar.

- Cast iron housing
- B-type or L3-type seals
- Wide inner race bearing

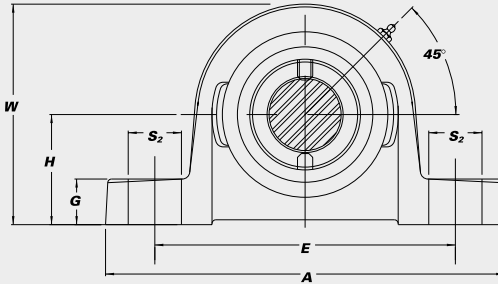
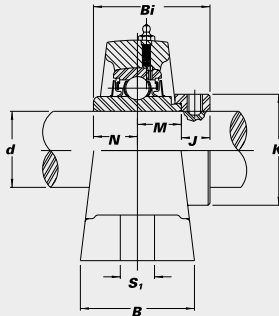

Unit No.	Shaft Dia.		Dimensions													Bolt Used	Bearing No.	Housing No.	Weight (lbs.)		
	d	d	H	A	E	B	S ₂	S ₁	G	W	Bi	N	M	J	K					(in.)	
NAPL 201		12																NAW 201			
201-8	1/2																	201-8			
202		15	1 1/16	4 7/8	3 5/8	1 7/16	3/4	7/16	1 7/32	2 5/64	1.4685	0.5472	0.5472	0.3740	1.1260		3/8	PL 203	1.5		
202-10	5/8		27	124	92	37	19	11	13	57	37.3	13.9	13.9	9.5	28.6						
203		17																			
NAPL 204-12		20	1 1/4	5	3 3/4	1 1/2	9/16	7/16	9/16	2 1/2	1.7126	0.6693	0.6693	0.3740	1.3110		3/8	NA 204-12	1.7		
204	3/4		31.8	127	95	38	14	11	14	64	43.5	17.0	17.0	9.5	33.3			204			
NAPL 205-14		25	1 5/16	5 1/2	4 1/8	1 1/2	1 1/16	7/16	5/8	2 5/64	1.7441	0.6850	0.6850	0.3740	1.5000		3/8	NA 205-14	2.0		
205-15	7/8		33.3	140	105	38	18	11	16	69	44.3	17.4	17.4	9.5	38.1			205-15			
205	1 5/16																				
205-16	1																				
NAPL 206-17		30	1 1/16	6 1 1/2	4 3/4	1 3/4	1 3/16	9/16	1 1/16	3 5/32	1.9016	0.7165	0.7165	0.4685	1.7520		1/2	NA 206-17	3.0		
206-18	1 1/8		39.7	161	121	45	21	14	18	80	48.3	18.2	18.2	11.9	44.5			206-18			
206	1 3/16																				
206-19	1 1/4																				
206-20	1 1/4 S																				
NAPL 207-20		35	1 13/16	6 1 9/32	5	1 7/8	7/8	9/16	2 5/32	3 1/32	2.0118	0.7402	0.7402	0.5315	2.1890		1/2	NA 207-20	4.1		
207-21	1 1/16		46.0	167	127	48	22	14	20	93	51.1	18.8	18.8	13.5	55.6			207-21			
207-22	1 3/8																				
207	1 1/16																				
207-23	1 1/16																				
NAPL 208-24		40	1 15/16	7 1/8	5 7/16	2	7/8	9/16	1 3/16	4	2.2165	0.8425	0.8425	0.5315	2.3740		1/2	NA 208-24	5.3		
208-25	1 7/16		49.2	181	137	51	22	14	21	102	56.3	21.4	21.4	13.5	60.3			208-25			
208																					
NAPL 209-26		45	2 1/16	7 1/2	5 3/4	2 1/8	1 3/16	9/16	2 9/32	4 7/32	2.2165	0.8425	0.8425	0.5315	2.5000		1/2	NA 209-26	6.1		
209-27	1 1/16		52.4	191	146	54	20	14	23	107	56.3	21.4	21.4	13.5	63.5			209-27			
209-28	1 3/4																				
209																					
NAPL 210-30		50	2 5/16	8 1 1/2	6 1/4	2 1/4	1 5/16	1 1/16	2 9/32	4 2 5/64	2.4685	0.9685	0.9685	0.5315	2.7520		5/8	NA 210-30	7.0		
210-31	1 15/16		55.6	204	159	57	24	18	23	113	62.7	24.6	24.6	13.5	69.9			210-31			
210																					
210-32	2S																				
NAPL 211-32		55	2 7/16	8 5/8	7	2 3/8	1 5/16	1 1/16	1	4 1 5/64	2.8110	1.0906	1.0906	0.6299	3.0000		5/8	NA 211-32	9.3		
211-34	2 1/8		61.9	219	178	60	24	18	25.4	126	71.4	27.7	27.7	16.0	76.2			211-34			
211																					
211-35	2 5/16																				
NAPL 212-36		60	2 1 1/16	9 1/16	7 3/8	2 1/2	1	1 1/16	1 1 1/32	5 1 3/32	3.0630	1.2165	1.2165	0.6299	3.3150		5/8	NA 212-36	11.6		
212	2 1/4		68.3	240	187	63	25.4	18	26.5	137	77.8	30.9	30.9	16.0	84.2			212			
212-38	2 3/8																				
212-39	2 1/16																				
NAPL 213-40		65	2 1 1/16	9 3/4	7 5/8	2 3/4	1 1/8	1 1/16	1 1/8	5 7/16	3.3740	1.3425	1.3425	0.6890	3.3858		5/8	NA 213-40	13.8		
213	2 1/2		68.3	248	194	70	29	18	29	138	85.7	34.1	34.1	17.5	86.0			213			
NAPL 215-47		75	3 1/4	10 3/16	8 1/2	2 5/16	1 1/4	1	1 1/8	6 3 3/64	3.6260	1.4685	1.4685	0.6890	4.0157		7/8	NA 215-47	18.3		
215	2 15/16		82.6	275	217	75	31	25.4	29	166	92.1	37.3	37.3	17.5	102.0			215			
215-48	3																				

Interchange Page 91