

# NAP Pillow Blocks



B-type Seal



L3-type Seal

**Standard duty. High shaft height with eccentric locking collar.**

- Cast iron housing
- B-type or L3-type seals
- Wide inner race bearing

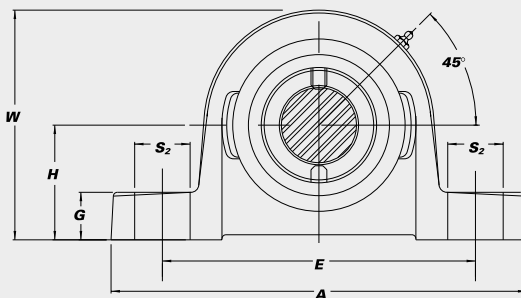
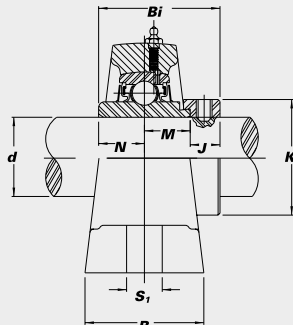

Unit No.	Shaft Dia.		Dimensions (in.) (mm)											Bolt Used (in.)	Bearing No.	Housing No.	Weight (lbs.)					
	d (in.)	d (mm)	H	A	E	B	S <sub>2</sub>	S <sub>1</sub>	G	W	Bi	N	M					J	K			
NAP 201		12																NAW201				
201-8	1/2																		201-8			
202		15	3/16	4/8	3/8	1/16	3/4	7/16	11/32	23/64	1.4685	0.5472	0.5472	0.3740	1.1260	3/8		202	P 203	1.6		
202-10	5/8																		202-10			
203		17																	203			
NAP 204-12	3/4		1 5/16	5	3 3/4	1 1/2	1 1/16	7/16	9/16	2 19/32	1.7126	0.6693	0.6693	0.3740	1.3110	3/8		NA 204-12	P 204	1.7		
204		20	33.3	127	95	38	17	11	14	66	43.5	17.0	17.0	9.5	33.3			204				
NAP 205-14	7/8		1 7/16	5 1/2	4 1/8	1 1/2	1 1/16	1/2	5/8	2 17/32	1.7441	0.6850	0.6850	0.3740	1.5000	3/8		NA 205-14	P 205	2.1		
205-15	1 1/16																		205-15			
205		25	36.5	140	105	38	17	13	16	72	44.3	17.4	17.4	9.5	38.1			205				
205-16	1																		205-16			
NAP 206-17	1 1/16		1 11/16*	6 5/16	4 3/4	1 3/4	1 3/16	9/16	1 1/16	3 19/64	1.9016	0.7165	0.7165	0.4685	1.7520	1/2		NA 206-17	P 206	3.1		
206-18	1 1/8																		206-18			
206		30	42.9	160	121	44	21	14	18	84	48.3	18.2	18.2	11.9	44.5			206				
206-19	1 3/16																		206-19			
206-20	1 1/4 S																		206-20			
NAP 207-20	1 1/4		1 1/8	6 17/32	5	2 29/32	7/8	9/16	3/4	3 11/16	2.0118	0.7402	0.7402	0.5315	2.1890	1/2		NA 207-20	P 207	4.2		
207-21	1 3/8																		207-21			
207-22	1 3/8		47.6	166	127	48	22	14	19	94	51.1	18.8	18.8	13.5	55.6			207-22				
207		35																	207			
207-23	1 7/8																		207-23			
NAP 208-24	1 1/2		1 15/16**	7 1/8	5 7/16	2	7/8	9/16	1 3/16	4	2.2165	0.8425	0.8425	0.5315	2.3740	1/2		NA 208-24	P 208	5.3		
208-25	1 7/8																		208-25			
208		40	49.2	181	137	51	22	14	21	102	56.3	21.4	21.4	13.5	60.3			208				
NAP 209-26	1 5/8		2 1/8	7 1/2	5 3/4	2 1/8	1 3/16	1 9/32	7/8	4 17/64	2.2165	0.8425	0.8425	0.5315	2.5000	1/2		NA 209-26	P 209	6.1		
209-27	1 11/16																		209-27			
209-28	1 3/4		54.0	190	146	54	21	15	22	109	56.3	21.4	21.4	13.5	63.5			209-28				
209		45																	209			
NAP 210-30	1 7/8		2 1/4	8	6 1/4	2 1/4	1 5/16	2 3/32	1 5/16	4 33/64	2.4685	0.9685	0.9685	0.5315	2.7520	5/8		NA 210-30	P 210	7.2		
210-31	1 15/16																		210-31			
210		50	57.2	203	159	57	24	18	24	115	62.7	24.6	24.6	13.5	69.9			210				
210-32	2 S																		210-32			
NAP 211-32	2		2 1/2	8 5/8	6 7/8	2 3/8	1 5/16	2 3/32	1 1/16	5 1/32	2.8110	1.0905	1.0905	0.6300	3.0000	5/8		NA 211-32	P 211	9.4		
211-34	2 1/8																		211-34			
211		55	63.5	220	174	60	24	18	27	128	71.4	27.7	27.7	16.0	76.2			211				
211-35	2 3/16																		211-35			
NAP 212-36	2 1/4		3	10 1/16	8	2 3/4	1 13/16	1	1 7/64	6 1/32	3.3740	1.3425	1.3425	0.6890	3.3858	7/8		NA 212-36	P 212	11.9		
212		60	69.8	242	187	64	25.4	20	27	140	77.8	30.9	30.9	16.0	84.2			212				
212-38	2 3/8																		212-38			
212-39	2 1/16																		212-39			
NAP 213-40	2 1/2		76.2	265	203	70	30	25.4	28	153	85.7	34.1	34.1	17.5	86.0			NA 213-40	P 213	14.0		
213		65																	213			
NAP 215-47	2 15/16		3 1/4	10 3/16	8 1/2	2 15/16	1 1/4	1	1 1/8	6 23/64	3.6260	1.4685	1.4685	0.6890	4.0157	7/8		NA 215-47	P 215	18.3		
215		75	82.6	275	217	75	31	25.4	29	166	92.1	37.3	37.3	17.5	102.0			215				
215-48	3																		215-48			

Interchange Page 91 \*Also available 1 1/8" \*\*Also available 2 1/8"

STANDARD PRODUCTS

11