

NA & NAW Bearing Inserts



B-type Seal



L3-type Seal

Standard duty with eccentric locking collar.

- Wide inner race
- B-type or L3-type seals

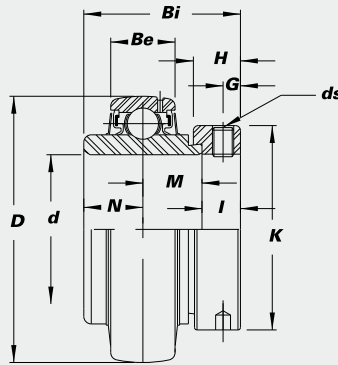

Bearing No.	Bore Dia. of Bearing		Dimensions (in. (mm))										Basic Load Rating (lbs.)	Basic Static Load Rating (lbs.)	Weight (lbs.)	
	<i>d</i>		<i>D</i>	<i>Bi</i>	<i>Be</i>	<i>N</i>	<i>M</i>	<i>I</i>	<i>K</i>	<i>H</i>	<i>G</i>	<i>Ds</i>				
	(in.)	(mm)														
NAW 201	12															0.35
201-8	1/2	15	1.5748	1.4685	0.5906	0.5472	0.5472	0.3740	1.1260	0.5315	0.1890	1/4-28UNF	2,040	1,020	0.35	
202			40.0	37.3	15.0	13.9	13.9	9.5	28.6	13.5	4.8				0.31	
202-10	5/8	17													0.31	
203															0.29	
NA 201	12															0.64
201-8	1/2	15	1.8504	1.7126	0.6299	0.6693	0.6693	0.3740	1.3110	0.5315	0.1890	1/4-28UNF	2,740	1,600	0.62	
202			47.0	43.5	16.0	17.0	17.0	9.5	33.3	13.5	4.8				0.60	
202-10	5/8	17														
203																
204-12	3/4	20														
204																
NA 205-14	7/8	25	2.0472	1.7441	0.6693	0.6850	0.6850	0.3740	1.5000	0.5315	0.1890	1/4-28UNF	3,010	1,750	0.64	
205-15	15/16		52.0	44.3	17.0	17.4	17.4	9.5	38.1	13.5	4.8				0.60	
205																
205-16	1															
NA 206-17	1 1/16	30	2.4409	1.9016	0.7480	0.7165	0.7165	0.4685	1.7520	0.6260	0.2362	5/16-24UNF	4,200	2,430	0.99	
206-18	1 1/8		62.0	48.3	19.0	18.2	18.2	11.9	44.5	15.9	6.0				0.95	
206																
206-19	1 3/16															
206-20	1 1/4 S															
NA 207-20	1 1/4	35	2.8346	2.0118	0.7874	0.7402	0.7402	0.5315	2.1890	0.6890	0.2677	5/16-24UNF	5,535	3,340	1.50	
207-21	1 5/16		72.0	51.1	20.0	18.8	18.8	13.5	55.6	17.5	6.8				1.43	
207-22	1 3/8															
207																
207-23	1 7/16															
NA 208-24	1 1/2	40	3.1496	2.2165	0.8268	0.8425	0.8425	0.5315	2.3740	0.7205	0.2677	5/16-24UNF	6,375	3,960	1.83	
208-25	1 9/16		80.0	56.3	21.0	21.4	21.4	13.5	60.3	18.3	6.8				1.77	
208																
NA 209-26	1 5/8	45	3.3465	2.2165	0.8661	0.8425	0.8425	0.5315	2.5000	0.7205	0.2677	5/16-24UNF	7,110	4,460	2.22	
209-27	1 11/16		85.0	56.3	22.0	21.4	21.4	13.5	63.5	18.3	6.8				2.01	
209-28	1 3/4															
209																
NA 210-30	1 7/8	50	3.5433	2.4685	0.9449	0.9685	0.9685	0.5315	2.7520	0.7205	0.2677	5/16-24UNF	7,400	4,910	2.38	
210-31	1 9/16		90.0	62.7	24.0	24.6	24.6	13.5	69.9	18.3	6.8				2.29	
210																
210-32	2 S															
NA 211-32	2	55	3.9370	2.8110	0.9843	1.0906	1.0906	0.6299	3.0000	0.8189	0.3150	3/8-24UNF	9,490	6,440	3.48	
211-34	2 1/8		100.0	71.4	25.0	27.7	27.7	16.0	76.2	20.8	8.0				3.30	
211																
211-35	2 3/16															
NA 212-36	2 1/4	60	4.3307	3.0630	1.0630	1.2165	1.2165	0.6299	3.3150	0.8740	0.3150	3/8-24UNF	11,500	7,490	4.48	
212			110.0	77.8	27.0	30.9	30.9	16.0	84.2	22.2	8.0				4.12	
212-38	2 3/8															
212-39	2 7/16															
NA 213-40	2 1/2	65	4.7244	3.3740	1.1024	1.3425	1.3425	0.6890	3.3858	0.9252	0.3346	3/8-24UNF	12,400	8,760	5.53	
213			120.0	85.7	28.0	34.1	34.1	17.5	86.0	23.5	8.5				5.31	
NA 214-44	2 3/4	70	4.9213	3.3740	1.1811	1.3425	1.3425	0.6890	3.5433	0.9252	0.3346	3/8-24UNF	13,530	9,620	5.80	
214			125.0	85.7	30.0	34.1	34.1	17.5	90.0	23.5	8.5				5.67	
NA 215-47	2 5/16	75	5.1181	3.6260	1.2598	1.4685	1.4685	0.6890	4.0157	0.9252	0.3346	3/8-24UNF	14,620	10,540	6.26	
215			130.0	92.1	32.0	37.3	37.3	17.5	102.0	23.5	8.5				6.04	
215-48	3															