

Corrosion Resistant Bearing & Housing Solutions

Bearing Insert Options

SUC, SNA, SSB – Stainless Steel

The most common solution for hostile chemical wash down applications, IPTCI's stainless inserts are composed of the following:

Balls & Rings	440 Stainless Steel
Set Screws	304 Stainless Steel
Slinger & Seal Frame	302 Stainless Steel
Retainer	302 Stainless Steel
Eccentric Collar (SNA only)	304 Stainless Steel
Seal	Silicone Rubber
Lubrication	H-1 Food Grade Grease
Operating Temp. Range	-10° F to 250° F



SSER – Stainless Steel ER Style

With the same component composition of SUC, SSER is designed to keep your cylindrical applications turning in corrosive environments. Also see black oxide ER bearings.



CUC – Hard Chrome Coated

Highly effective for intermediate wash down applications, chrome coated inserts can dramatically extend bearing life beyond that of other plated bearing products. CUC inserts are composed of the following:

Rings	Hard Chrome Coated
Balls	440 Stainless Steel
Set Screws	304 Stainless Steel
Slinger & Seal Frame	302 Stainless Steel
Retainer	302 Stainless Steel*
Seal	Silicone Rubber
Lubrication	H-1 Food Grade Grease
Operating Temp. Range	-10° F to 250° F



*chrome coated for sizes 213-215

BUC – Black Oxide

A popular choice for mildly corrosive applications. Also see Black Oxide ER and Black Oxide High Temperature HUC bearings.



Housing Options

304 Stainless Steel

Stainless steel housings are generally the most effective solution for highly corrosive applications. They do not experience the same flaking, cracking, deformation or discoloration issues associated with other corrosion resistant housing materials. They are virtually unaffected by scrapes and can easily handle significant radial loads.

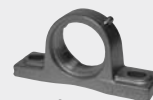

To reduce residual contaminants, IPTCI stainless housings are made with extremely smooth surfaces and have solid bases and backs. Many styles are also available with end caps.

Thermoplastic

Where proven corrosion resistance must be balanced with more favorable economics, IPTCI's thermoplastic housings are an excellent choice, and can be assembled with any insert in our catalog.



IPTCI's thermoplastic housings are off-white in color and made from glass reinforced PBT resin. Along with excellent chemical resistance, this high performance grade plastic offers very favorable mechanical, thermal and electrical properties. Also, compared with other types of plastics, IPTCI thermoplastic is very resistant to moisture absorption. Operating temperature range is -10° F to 210° F.

Like our stainless steel housings, IPTCI thermoplastic housings are made with extremely smooth surfaces and have solid bases and backs. All sleeves, bushings and grease fittings used in our thermoplastic units are made from 300 series stainless steel.

Nickel Plated

Used with stainless, hard chrome coated, or black oxide inserts, IPTCI's copper nickel chrome housings are a common choice when the housing requires mild to intermediate corrosion protection.



End Caps

For additional protection from contamination, or for increased personnel safety, many of IPTCI's stainless and thermoplastic housings are available with plastic end caps.